

RUGGED COVER

Hard Tri-Fold Tonneau Installation Instructions

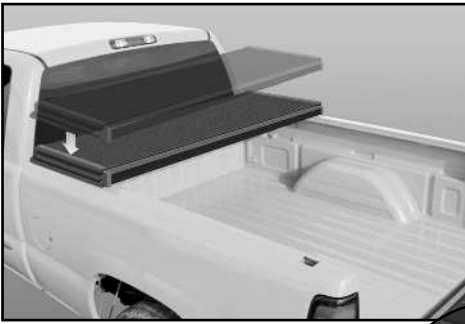

1. Place the cover on front of truck bed.

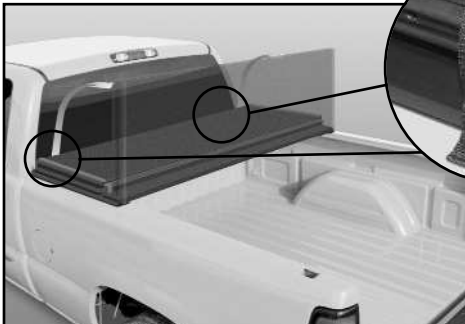

2. Undo both tie-down straps so cover can be unfolded.



3. Unfold the cover all the way open to align cover on the truck bed rails before clamping.

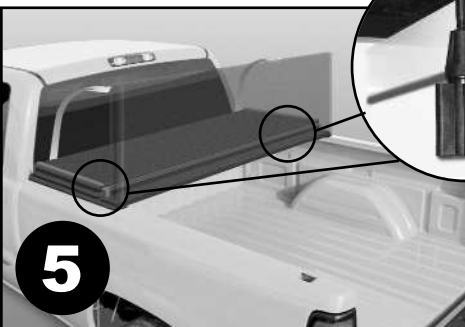

4. Secure cab clamp hooks under the metal bed rail.



5. Unfold first section.

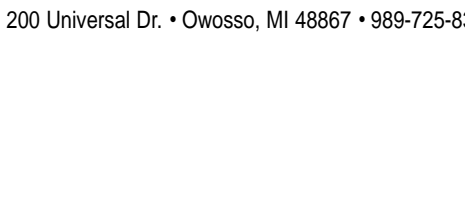

6. Unfold second section.

Patent Pending

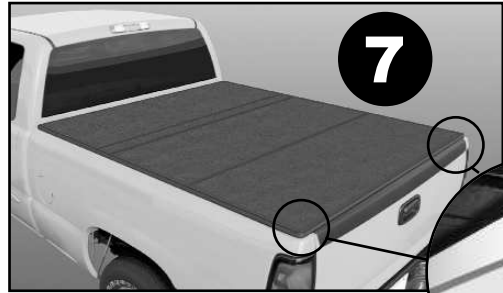

7. Cover is laying down flat.

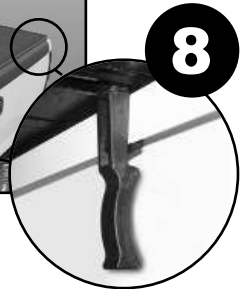

8a. Secure tailgate clamp hooks for a snug fit.

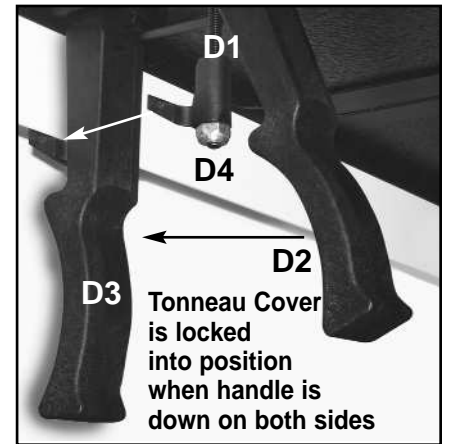

8b. To clamp cover down, put lip of clamp hooks under the side metal bed rail and push handle down. (See D1, D2, D3)

8c. When clamps are adjusted, tighten down nylon lock nut. (See D4)

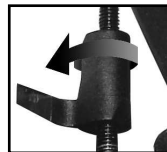

How To Adjust Clamps

- To adjust, turn clamp hook clockwise to tighten or counter clockwise to loosen.

9. Vehicles With Utility Track

A. Slide aluminum blocks into track, position and tighten set-screw.

B. Secure cab and tailgate clamp hooks on to aluminum blocks.

C. Tundra Models - Do not use lock nut (See D4). Loosen 2 rear bolts. Slide blocks into track. Then re-tighten 2 rear bolts.

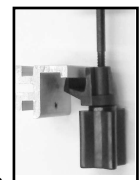

Cab



Tailgate

10. Paint Protectors

A. Apply to inside metal bed rail at each latch location